

English

79
A

IMPORTANT SAFETY RULES

Read, understand, and follow
all instructions carefully before
installing and using this product.
Keep for future reference.

ZX500R Robotic Pool Cleaner

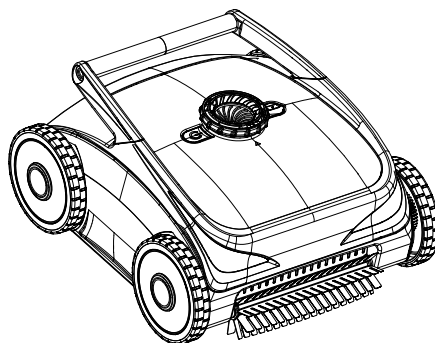

For illustrative purposes only.

Don't forget to try these other fine Intex products:
pools, pool accessories, inflatable pools and in-home
toys, airbeds and boats available at fine retailers or
visit our website.

Due to a policy of continuous product improvement,
Intex reserves the right to change specifications and
appearance, which may result in updates to the
instruction manual without notice.

INTEX®

©2025 Intex Marketing Ltd. - Intex Development Co. Ltd. - Intex Recreation Corp. All rights reserved/Tous droits réservés/Todos los derechos reservados/Alle Rechte vorbehalten. Printed in China/Imprimé en Chine/Impreso en China/Gedruckt in China.

®™ Trademarks used in some countries of the world under license from/®™ Marques utilisées dans certains pays sous licence de/Marcas registradas utilizadas en algunos países del mundo bajo licencia de/Warenzeichen verwendet in einigen Ländern der Welt in Lizenz von/Intex Marketing Ltd. to/à/a/an Intex Development Co. Ltd., Hong Kong & Intex Recreation Corp., P.O. Box 1440, Long Beach, CA 90801 • Distributed in the European Union by/Distribué dans l'Union Européenne par/Distribuido en la unión Europea por/Vertrieb in der Europäischen Union durch/Intex Trading B.V., Ettenseweg 46, 4706 PB Roosendaal - The Netherlands • Distributed in the UK by Unites Service (UK) Limited, 21 Holborn Viaduct, London EC1A 2DY, UK.

www.intexcorp.com

079-A*-R1-2511

OWNER'S MANUAL

TABLE OF CONTENTS

Warnings.....	3
Product Specifications.....	4
Parts Reference.....	5
Operating Instructions.....	6-7
Detailed Operating Instructions.....	8-13
Long Term Storage.....	13
Troubleshooting Guide.....	14
Limited Warranty.....	15

SAVE THESE INSTRUCTIONS

IMPORTANT SAFETY RULES

Read, Understand and Follow All Instructions Carefully Before Installing and Using this Product.



WARNING

- Assembly and disassembly by adults only. This is not a toy.
- This appliance can be used by children aged from 8 years and above and persons with reduced physical, sensory or mental capabilities or lack of experience and knowledge if they have been given supervision or instruction concerning use of the appliance in a safe way and understand the hazards involved.
- Children shall not play with the appliance. Cleaning and user maintenance shall not be made by children without supervision.
- The appliance must only be supplied at safety extra low voltage corresponding to the marking on the appliance.
- Do not use if unit is damaged in any way. Replace damaged components promptly.
- This cleaner creates suction. Keep hair, loose clothing, fingers, and any body parts away from openings and moving parts.
- Use only accessories and replacement parts specified in this manual.
- Never leave this product plugged into the main outlet for long term storage.
- Never leave this product in the water when it is OFF or has run out of battery power.
- **Do not use this product for pool opening (start of the season). This product is design for routine general maintenance of your pool. Do not use for cleaning of longer accumulated heavy dirt such as at the start of the pool season.**
- This product is designed for underwater use: must be submerged to operate properly. Do not use this product as an all-purpose vacuum cleaner.
- Do not use this product without the filter and/or cleaner cover.
- Do not vacuum sharp objects, as this may damage the filter.
- Do not vacuum toxic substances, flammable or combustible liquids such as gasoline, or operate in the presence of explosive or flammable fumes.
- Never insert or drop objects into any opening on the device. Keep all openings free of leaves, debris, or anything that may reduce the water flow.
- Do not operate the device when people or animals are in the pool.
- Always turn off and unplug the device before cleaning, servicing, changing the filter or any routine maintenance.
- Do not charge the product with a damaged plug charger.
- Charge the product indoors in a clean and dry place. Do not expose to rain or extreme temperature and do not handle with wet hands during charging. Never charge the product while operating it.
- This product contains sealed non-replaceable Lithium-ion (Li-ion) rechargeable batteries. Do not dispose of the product in regular trash, municipal waste stream or by fire as the built-in rechargeable battery may leak or explode. Always dispose of the batteries safely in accordance with your local law and regulations.
- This product is intended to be used only for the purposes described in the manual.
- Charging operations shall be carried out in accordance with the instructions in "Charging the Battery" section.

FOLLOW THESE RULES AND ALL INSTRUCTIONS TO AVOID PROPERTY DAMAGE OR OTHER INJURY.

SAVE THESE INSTRUCTIONS

PRODUCT SPECIFICATIONS

English

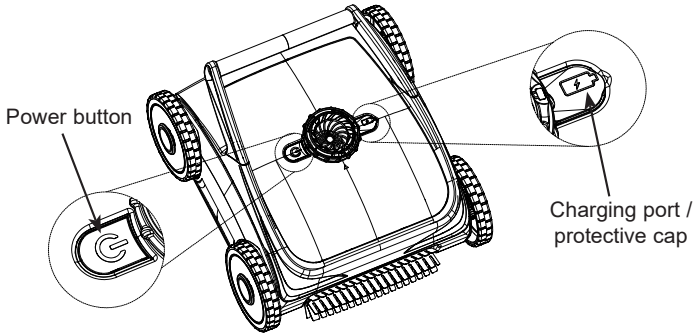
79
A

Model:	ZX500R
Charger input:	220-240 V AC, 50/60 Hz
Charger output:	16 V DC, 3.5 A
Maximum working power:	46 W
Battery voltage/capacity:	12.8 V DC, 7.5 Ah
Charging time:	3 hours
Full charge operating time:	Up to 2 hours
Maximum cleaning area:	Up to 176 m ² (1894 ft ²)
Maximum water depth:	≤ 2 m (78.7 in)
Waterproof grade:	IPX8
Operating water temperature:	10~32 °C (50~90 °F)
Storage temperature:	0~40 °C (32~104 °F)
Pool water chemical level requirement:	pH: 7.0-7.4
	Free Chlorine: up to 4 ppm
	NaCl: up to 5000 ppm

Suitable for all above-ground pools and in-ground* pools with a maximum depth of 2 m (78.7 in).

* Results may vary based on pool surface type — Suitable for plaster and vinyl-lined pools; not suitable for above-ground pools with an inflatable top ring.

NOTE: Wall climbing requirement - make sure the angle between the inner wall of the pool and the ground is greater than or equal to 90 degrees. If the angle between the inner wall of the pool and the ground is less than 90 degrees, the cleaner will not be able to climb the wall.

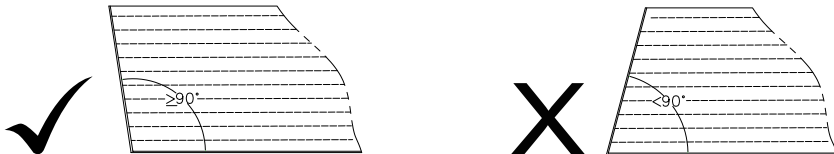

SAVE THESE INSTRUCTIONS

PARTS REFERENCE

English

79
A

The following is a breakdown of replaceable parts.

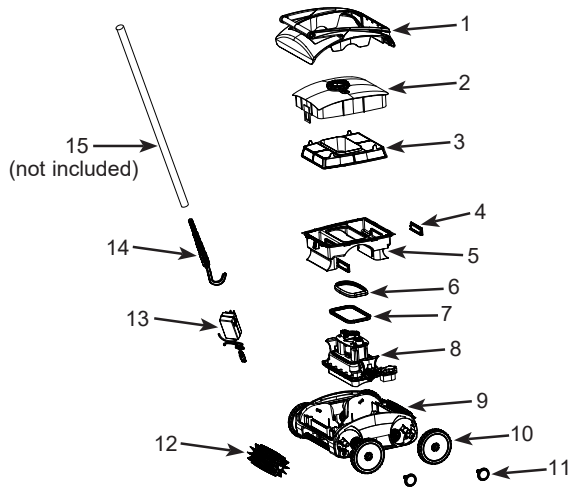

NOTE: Drawings for illustration purpose only. Actual product may vary. Not to scale.

REF. NO.	DESCRIPTION	QTY.	SPARE PARTS NO.
1	CLEANER TOP	1	13498
2	UPPER LID OF THE DEBRIS CONTAINER	1	13499
3	FILTER	1	13502
4	SIDE FILTER	2	13509
5	DEBRIS CONTAINER	1	13503
6	TOP GASKET	1	13500
7	BOTTOM GASKET	1	13501
8	DRIVE MODULE	1	13504
9	CLEANER BASE	1	13505
10	WHEEL	4	13508
11	WHEEL LOCKER	4	13507
12	ROLLER BRUSH	2	13506
13	CHARGER	1	13512
14	HOOK	1	13510
15	POLE (NOT INCLUDED)	1	10637A

When ordering parts, be sure to quote the model number and part numbers.

SAVE THESE INSTRUCTIONS

OPERATING INSTRUCTIONS

English

79
A

Instructions before use:

- The cleaner is only suitable for operation in water.
- The cleaner is only suitable for cleaning large particles, debris and leaves; it cannot replace the filtering effect of the filter pump.
- The cleaner is not suitable for use in environments with algae. The pool wall or floor are free from algae. Algae will cause the wheels to slip, block the flow of water into the cleaner and hinder the cleaner movement. Treat the pool water with algaecide and wait for the algae to shed before using the cleaner. See your local pool supply specialist for algae treatment solutions.
- If the filter pump of the pool is running simultaneously with the cleaner, and the suction or spray of the filter pump affects the operation of the cleaner, the filter pump should be turned off first.
- The pool is free from objects that will hinder the cleaner free movements by removing the ladder, surface skimmer, water sprayer (if applicable), floats, strainer grid or any other objects from the pool.
- If the water is too dirty, check and clean the filter net and debris container **(5)** more frequently during the operating process.

Preparation before use:

- a. The cleaner needs to be fully charged.
- b. The debris container is installed correctly on the cleaner.
- c. The wheel brushes are properly installed on the cleaner.

Quick steps for using the cleaner: (For first-time users, please refer to the "Detailed Operating Instructions")

1. **Starting location in the pool:** Place the cleaner in the middle of the pool. For non-round pools, place it in the middle of the long side of the pool as shown below.

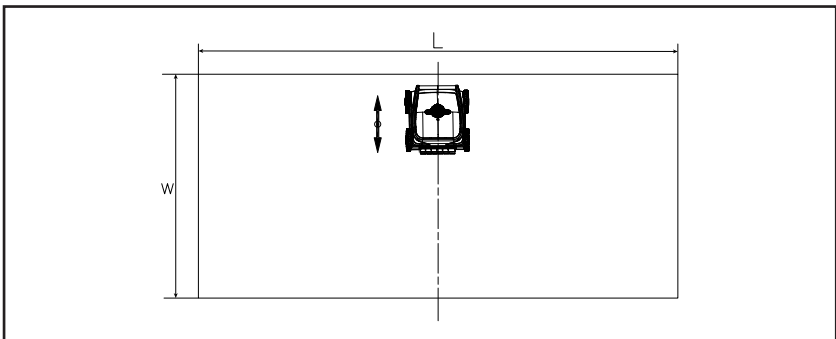

SAVE THESE INSTRUCTIONS

OPERATING INSTRUCTIONS (continued)

English

79
A

- Air exhaustion:** Submerge and hold the cleaner under the pool water for more than 5 seconds to exhaust all the air out of the cleaner. Do not lower the cleaner to the bottom of the pool yet.

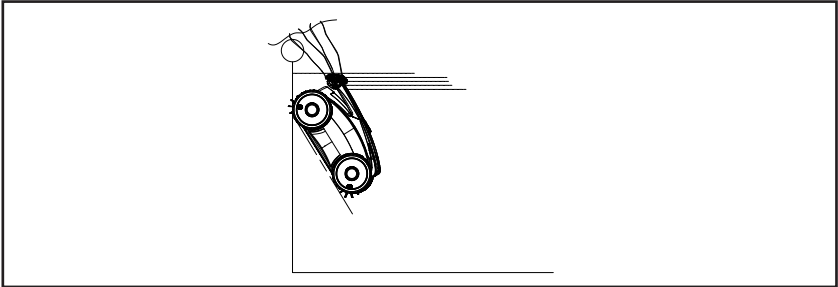

- Pool shape selection:** (see “Detailed Operating Instructions”)
Hold the cleaner under water with one hand, and turn **ON** the cleaner to reveal the power button light color:
GREEN light is for round pools path mode
BLUE light is for non-round pools path mode
Turn the power button **OFF** and **ON** again to change the pool shape selection.

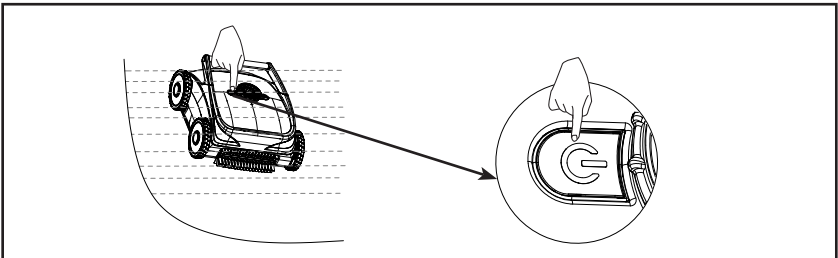

- Release the cleaner, let it sink to the floor.**

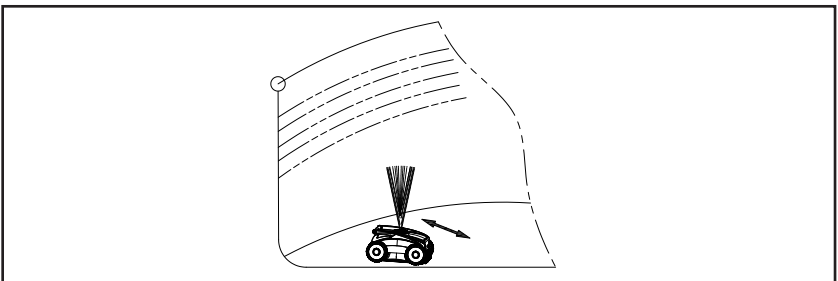

SAVE THESE INSTRUCTIONS

DETAILED OPERATING INSTRUCTIONS English**79
A****Detailed instructions for preparation before use:****a. Fully charged the battery:**

- Open the protective cap of the charging port, insert the output port of the charger into the charging port of the cleaner, and plug the charger into the main electrical outlet. See Fig. 1.

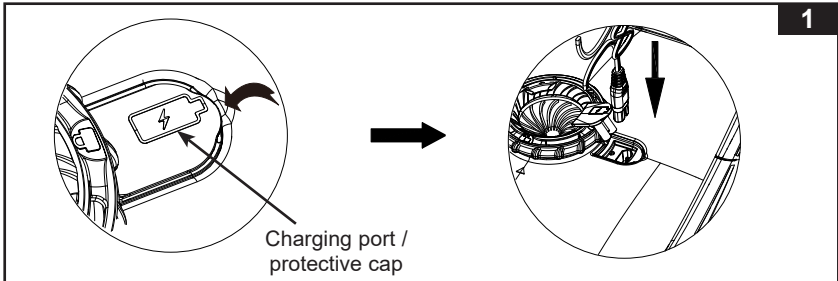

- During charging, the indicator light will flash between red and green, and the green light will stay on continuously when the battery is fully charged.
- Once fully charged, unplug the power cord and cover the charging port with the protective cap. See Fig. 2.

NOTE: After unplugging the charger, the indicator light will turn off.

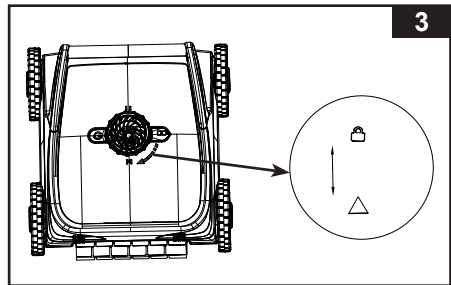
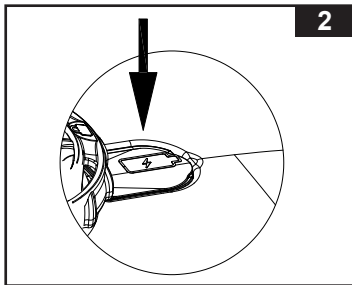
**b. Install the debris container in the correct position:**

- Ensure that the set of debris container is properly assembled on the cleaner by tightening the nut clockwise until the mark 🔒 is aligned with the mark △. See Fig. 3.

SAVE THESE INSTRUCTIONS

DETAILED OPERATING INSTRUCTIONS (continued) English**79
A****c. Install the wheel brushes in the correct position:**

- Make sure that the wheel brushes are installed in the front and back of the cleaner. See Fig. 4.

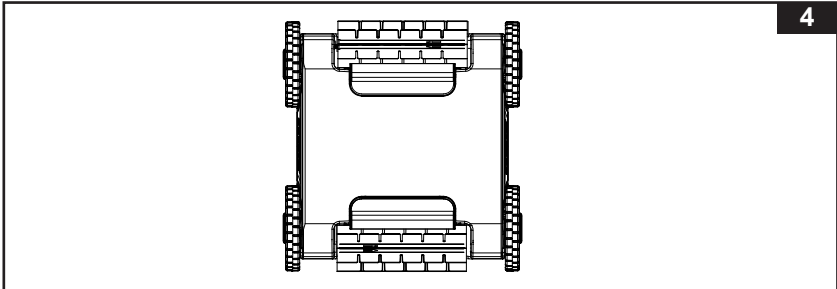

- Installation of wheel brushes: Align the convex shaft of the wheel brush with the groove on the cleaner, look for the arrow on the brush, hold the brush and push the wheel brush in the direction of the arrow, align the other end of the wheel brush with the groove on the other end of the cleaner, and release it to install the wheel brush. See Fig. 5.

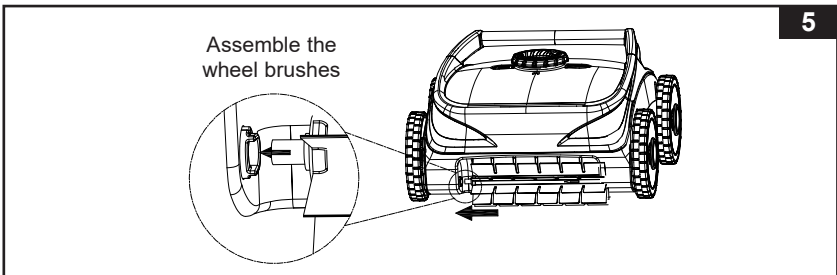

- Removal of the wheel brushes: Look for the arrow on the brush. Hold the brush and push the wheel brush in the direction of the arrow, pulling it up or down to remove the wheel brush. See Fig. 6.

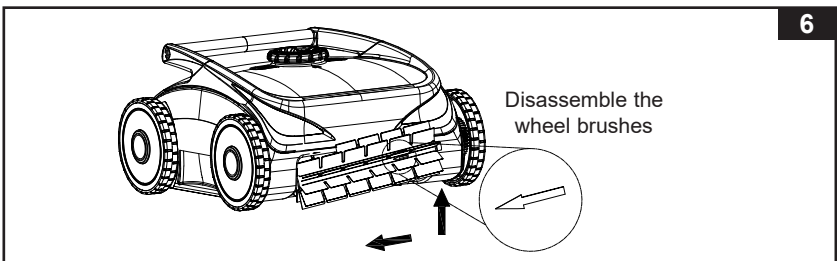
**SAVE THESE INSTRUCTIONS**

DETAILED OPERATING INSTRUCTIONS (continued) English**79
A****Detailed steps for using the cleaner:**

1. Hold the handle of the cleaner and take it to the pool.

NOTE: For rectangular shape pools, it is recommended to place the cleaner in the middle of the long side. See Fig. 7.

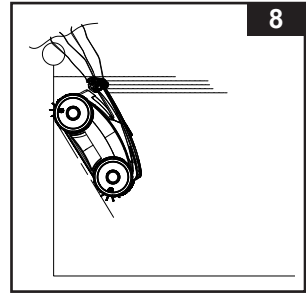
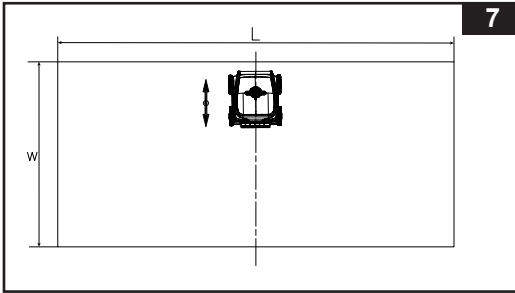

2. Grasp the handle of the cleaner with both hands, immerse the cleaner in water, and swing it back and forth 3-5 times to exhaust all the air. See Fig. 8. Align the handle parallel to the water surface, and with the front of the cleaner facing downwards, release the cleaner to the bottom of the pool.

3. **Select the cleaner operating path mode according to the shape of the pool first.**

Press the power button (⏻) to turn ON and reveal the power button light color, see Fig. 9:

GREEN light is for round pools path mode

BLUE light is for non-round pools path mode
--

To change the path mode (power button light color), turn OFF and turn ON the power button again. Repeat this cycle to change the path mode.

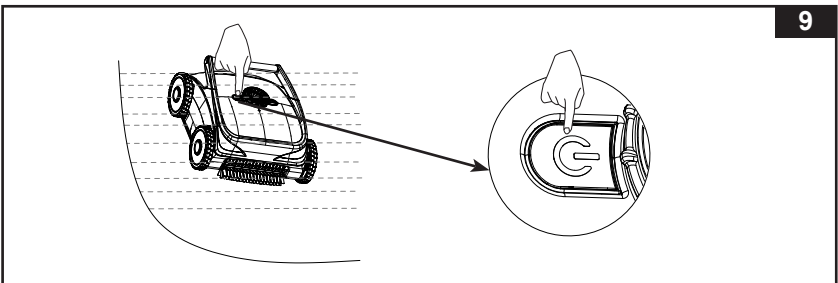

SAVE THESE INSTRUCTIONS

DETAILED OPERATING INSTRUCTIONS (continued) English**79
A**

- Description of the indicator lights:

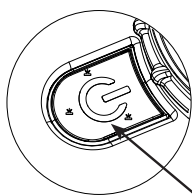

Transparent window
with LED indicator lights

Status	Indicator light
Working / power on	Blue light solid or green light solid
Power off	Light off
Drive module failure	Red light solid
Low battery	Red light flashing
Battery charging	Red/Green light slowly changing
Fully charged	Green light solid

4. Wait for about 15 seconds, the cleaner will spray water first, then it will start working according to the built-in program. See Fig. 10.

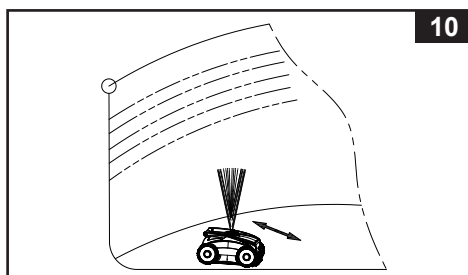

5. Remove the cleaner from the pool and turn it off.
 - a. When the cleaner battery is almost exhausted, the cleaner will move and stop next to the pool wall automatically for easy retrieval. Attach the hook (14) to a long pole (not included). Hook the cleaner handle and lift the cleaner out of the water slowly. See Fig. 11.

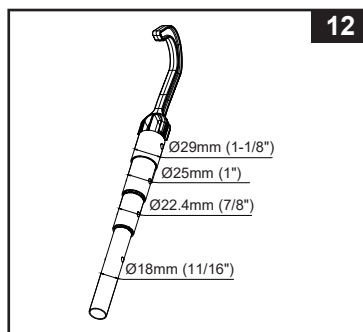
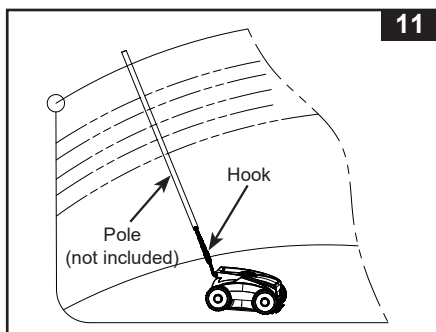

NOTE: The hook (14) fits most common pool maintenance poles. See Fig. 12.

- b. The pool is fully cleaned up, and the cleaner is still in working condition, wait for the cleaner to get close to the pool edge or climb the wall, **take out the cleaner halfway, and press the power button to shut off.**



SAVE THESE INSTRUCTIONS

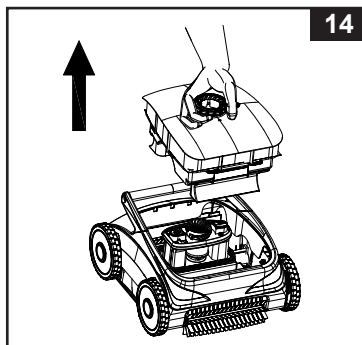
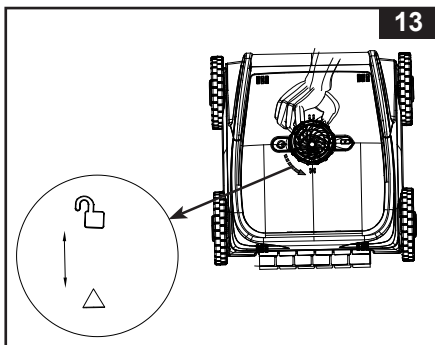

DETAILED OPERATING INSTRUCTIONS (continued) English**79
A****6. Clean the debris container.**

- Rotate the nut in a counterclockwise direction until the mark  aligns with the arrow mark . See Fig. 13.
- Hold the lock ring in your hand and take out the debris container. See Fig. 14.

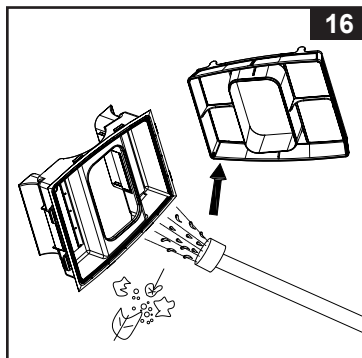
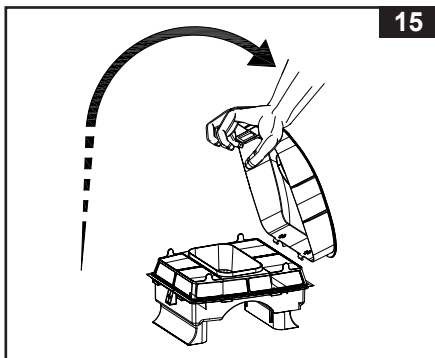

- Pull open the buckle with your hand and lift it up to open the lid of the debris container. See Fig. 15.
- Clean the filter net and debris container (5) with a garden hose. See Fig. 16.

**7. Put back the debris container. See Fig. 17.**

- Place the filter net into the debris container.
- Align the two hooks on the upper cover of the debris container into the two grooves of the debris container.
- Flip the lid of the debris container.
- Tighten the lid of the debris container tightly.
- Install the debris container component into the cleaner and rotate the locking ring clockwise until the mark  aligns with the arrow mark .

SAVE THESE INSTRUCTIONS

DETAILED OPERATING INSTRUCTIONS (continued) English

79
A

17

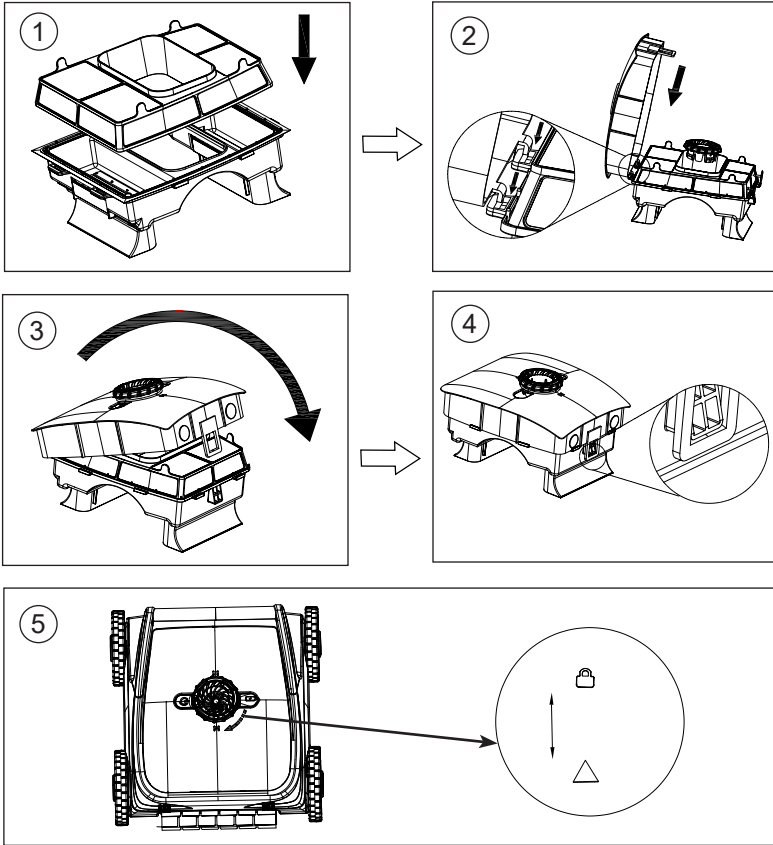

LONG TERM STORAGE

1. Clean and air dry all the accessories and parts thoroughly.
2. To protect and extend the life of the battery, make sure the battery is charged before long term storage, and charge the battery every 3 months thereafter.
3. Store the product in a dry, temperature-controlled between 0~40°C (32~104°F), indoor location with air ventilation.

NOTE: Do not store outdoors. Do not expose to sunlight.

4. The original packaging can be used for storage.

SAVE THESE INSTRUCTIONS

TROUBLESHOOTING GUIDE

English

79
A

TROUBLE	CAUSE	SOLUTION
The indicator light is blue or green, but the cleaner does not start	<ul style="list-style-type: none"> Lack of water or low water level. 	<ul style="list-style-type: none"> Make sure the pool is filled with water. Make sure the cleaner is fully submerged in the water.
Pressed the power button, the indicator light does not light up	<ul style="list-style-type: none"> The battery is dead. Drive module (8) is damaged. 	<ul style="list-style-type: none"> Charge the battery until the light is on. Replace the drive module (8).
The cleaner cannot sink to the pool bottom	<ul style="list-style-type: none"> There is air inside the cleaner. 	<ul style="list-style-type: none"> Shake the cleaner left and right under the water to remove any trapped air.
Cleaner can not climb the pool wall, sway left and right, or walk slowly	<ul style="list-style-type: none"> The filter screen is blocked. Low battery. Pool wall is covered by algae. The spray nozzle is blocked. The wheel axle and the roller brush axle are jammed due to the sediment. 	<ul style="list-style-type: none"> Clean the filter screen. Charge the battery. Clean the water with algicide or pool sanitizer chemicals. Clean the spray nozzle. Remove the wheels (10) and roller brushes (12), rinse off the sediment on the axle sleeve and reassemble.
Leakage of water spray nozzle/ Weakened water spraying ability	<ul style="list-style-type: none"> Loose or broken filters (3 & 4) opening. There are debris around the impeller. Excessive dirt inside the filter. 	<ul style="list-style-type: none"> Replace the filter. Clean the dirt on the impeller thoroughly. Clean the filter thoroughly.
Cleaner cannot pick up the debris as before	<ul style="list-style-type: none"> Loose or broken filters (3 & 4). Filters (3 & 4) are clogged with slime, dirt. The wheels (10) can move, but the roller brushes (12) cannot move. 	<ul style="list-style-type: none"> Check filters and replace them if broken. Clean the filters, and treat the water with algicide, sanitizer chemicals. Replace the roller brushes (12) and contact Intex Service Center.

IMPORTANT

If you continue to experience difficulty, please contact our Consumer Service Department for assistance. See separate "Authorized Service Centers" sheet.

SAVE THESE INSTRUCTIONS

Limited Warranty

Your ZX500R Robotic Pool Cleaner has been manufactured using the highest quality materials and workmanship. All Intex products have been inspected and found free of defects prior to leaving the factory. This Limited Warranty applies to the ZX500R Robotic Pool Cleaner only.

This limited warranty is in addition to, and not a substitute for, your legal rights and remedies. To the extent that this warranty is inconsistent with any of your legal rights, they take priority. For example, consumer laws across the European Union provide statutory warranty rights in addition to the coverage you receive from this limited warranty: for information on EU-wide consumer laws, please visit the European Consumer Center website at http://ec.europa.eu/consumers/ecc/contact_en/htm.

The provisions of this Limited Warranty apply only to the original purchaser and are not transferable. This Limited Warranty is valid for the period noted below from the date of the initial retail purchase. Keep your original sales receipt with this document, as proof of purchase will be required and must accompany warranty claims or the Limited Warranty will be invalid.

ZX500R Robotic Pool Cleaner Warranty – 2 Years

If you find a manufacturing defect in the ZX500R Robotic Pool Cleaner during the warranty period, please contact the appropriate Intex Service Center listed in the separate "Authorized Service Centers" sheet. If the item is returned as directed by the Intex Service Center, the Service Center will inspect the item and determine the validity of the claim. If the item is covered by the provisions of the warranty, the item will be repaired or replaced, with the same or comparable item (at Intex's choice) at no charge to you.

Other than this warranty, and other legal rights in your country, no further warranties are implied. To the extent possibly in your country, in no event shall Intex be liable to you or any third party for direct or consequential damages arising out of the use of your ZX500R Robotic Pool Cleaner, or Intex or its agents' and employees' actions (including the manufacture of the product). If your country does not allow the exclusion or limitation of incidental or consequential damages, this limitation or exclusion does not apply to you.

You should note that this limited warranty does not apply in the following circumstances:

- If the ZX500R Robotic Pool Cleaner is subject to negligence, abnormal use or application, accident, improper operation, improper voltage or current contrary to operating instructions, improper maintenance or storage;
- If the ZX500R Robotic Pool Cleaner is subject to damage by circumstances beyond Intex's control, including but not limited to, ordinary wear and tear and damage caused by exposure to fire, flood, freezing, rain, or other external environmental forces;
- To parts and components not sold by Intex; and/or.
- To unauthorized alterations, repairs or disassembly to the ZX500R Robotic Pool Cleaner by anyone other than Intex Service Center personnel.

Injury or damage to any property or person is not covered by this warranty.

Read the owner's manual carefully and follow all instructions regarding proper operation and maintenance of your ZX500R Robotic Pool Cleaner. Always inspect your product prior to use. This limited warranty will be void if use instructions are not followed.

SAVE THESE INSTRUCTIONS